

How to Use the CR-V Interior Lights

Front & Rear Lights

The front and rear light switches work the same way. They have three positions:

- **OFF:** In this position, the lights won't come on at any time.
- **DOOR:** In the door-activated position, the lights come on when any door is opened, when the driver's door is unlocked, or when the power mode is set to VEHICLE OFF.
- **ON:** The interior lights come on whether the doors are open or closed.

Front

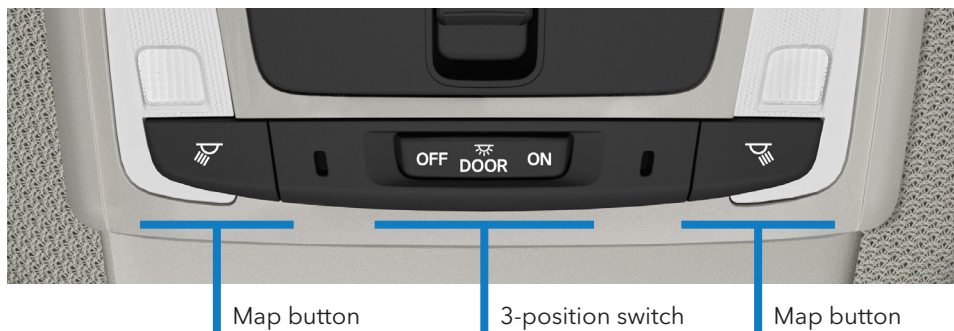

Rear

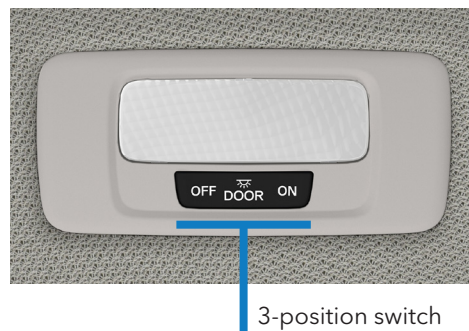

Map Lights

The map lights are turned on and off by pressing the switches.

Cargo Area Lights

The cargo area lights come on automatically when the tailgate is opened.