

	Smart Entry	Walk Away Auto Lock®	Bluetooth® HandsFreeLink®	Media Device Ports	Audio Systems	SiriusXM® Satellite Radio	Adaptive Cruise Control	Lane Keep Assist System	Forward Collision Warning	Road Departure Mitigation	Defroster/Defogger
Sport			•	•	Color Audio		•	•	•	•	•
LX			•	•	Color Audio		•	•	•	•	•
EX, EX-L Navi	•	•	•	•	Display Audio	•	•	•	•	•	•
Sport Touring	•	•	•	•	Display Audio	•	•	•	•	•	•
Type R	•	•	•	•	Display Audio	•					•

Let's personalize your vehicle

Your vehicle has many customizable settings. Refer to your Owner's Guide or Owner's Manual to see them in more detail.

AUTO DOOR LOCK: When do the doors automatically lock? (Sport, LX, EX, EX-L Navi, Sport Touring, Type R)

- ☐ With Vehicle Speed Doors and hatch lock when vehicle speed reaches approximately 10 mph.
- ☐ Shifting From Park (Continuously Variable Transmission models only) Doors and hatch lock when shift lever is moved out of Park (P).
- ☐ OFF Auto door lock function deactivated.

AUTO DOOR UNLOCK: When do the doors automatically unlock? (Sport, LX, EX, EX-L Navi, Sport Touring, Type R)

- ☐ When Driver's Door Opens All doors and hatch unlock when driver's door is opened.
- ☐ When Shifted to Park (Continuously Variable Transmission models only) All doors and hatch unlock when shift lever is moved to Park (P).
- ☐ When Ignition Switched Off (Models with Driver Information Interface) All doors and hatch unlock when power mode is set to VEHICLE OFF (LOCK).
- ☐ OFF Auto door-unlock function deactivated.

KEY AND REMOTE UNLOCK MODE: Which doors unlock on first push of the remote? (LX, EX, EX-L Navi, Sport Touring, Type R)

- ☐ Driver's Door Only ☐ All Doors

DOOR UNLOCK MODE: Changes which doors unlock when you grab the driver's door handle. (EX, EX-L Navi, Sport Touring, Type R)

- ☐ Driver's Door Only ☐ All Doors

WALK AWAY AUTO LOCK: Select whether the vehicle automatically locks when you walk away with the smart entry remote. (EX, EX-L Navi, Sport Touring, Type R) Video available at hondatechtutor.com

- ☐ ON ☐ OFF

RADIO PRESETS: Show the customer how to store a station.

1. Use the TUNE, SEEK or SCAN function to tune to a desired station or channel.
 2. Pick a preset number button (1-6 or 7-12, as appropriate).
 3. Press and hold the button until you hear a beep.
- AM _____

ADAPTIVE CRUISE CONTROL (ACC) FORWARD VEHICLE DETECT BEEP: Select whether the ACC system beeps when it detects a vehicle or when a detected vehicle goes out of ACC range. (Sport, LX, EX, EX-L Navi, Sport Touring) Video available at hondatechtutor.com

- ☐ ON ☐ OFF

LANE KEEPING ASSIST SYSTEM (LKAS) SUSPEND BEEP: Select whether the system beeps when the LKAS is suspended. (Sport, LX, EX, EX-L Navi, Sport Touring) Video available at hondatechtutor.com

- ☐ ON A beep confirms each time the system suspends (does not detect lane markings). ☐ OFF The system remains silent when it no longer detects lane markings.

FORWARD COLLISION WARNING DISTANCE: Change the distance at which Collision Mitigation Braking System™ alerts. (LX, Sport, EX, EX-L, Touring) Video available at hondatechtutor.com

- ☐ LONG ☐ NORMAL ☐ SHORT

ROAD DEPARTURE MITIGATION (RDM) SETTING: Change the setting for the RDM system. (Sport, LX, EX, EX-L Navi, Sport Touring) Video available at hondatechtutor.com

- ☐ NORMAL ☐ WIDE ☐ WARNING ONLY

AUDIO CONTROLS: Show customer how to use the audio controls.

COMPATIBLE PHONE PAIRED: Show customer how to pair a compatible phone.

HOOD: Show customer how to open the hood

APPLE CARPLAY™ / ANDROID AUTO™ (EX, EX-L Navi, Sport Touring, Type R): Offer to plug customer's USB cable into the port and show how to activate. Explain that extension cable is already installed.

REMOTE TRANSMITTER: Explain to customer they may experience interference due to proximity of mobile device to remote transmitter

Note: SiriusXM® Radio will not function in Alaska, Puerto Rico or Hawaii.

FM	_____	_____	_____	_____	_____
FM	_____	_____	_____	_____	_____
SXM	_____	_____	_____	_____	_____
SXM	_____	_____	_____	_____	_____

FOR MORE INFORMATION

To learn more about your model's features, visit:

owners.honda.com and hondatechtutor.com

Honda Customer Service: 1-800-999-1009

Monday through Friday: 6:00 AM to 5:00 PM - PT

[Twitter.com/HondaCustSvc](https://twitter.com/HondaCustSvc)

Technology Support: 1-888-528-7876

Monday through Friday: 6:00 AM to 5:00 PM - PT

Saturdays: 7:30 AM to 4:00 PM - PT

Owner's Guide located in glove box

Owner's Manual + Navigation Manual on website: owners.honda.com

For frequently asked questions, try our Virtual Chat: <https://hondaweb.com/a2q/chat>

For more information on Android Auto™: android.com/auto/

For more information on Apple CarPlay™: apple.com/ios/carplay/

Honda How to Playlist

hondahowtovideos.com

Videos on how to use various Honda technologies.

Customer's Name: _____ Initials: _____ VIN#: _____

Sales Consultant/Delivery Specialist: _____ Date: _____

The information herein is believed to be accurate at time of printing. It is offered without warranty or assumption of responsibility by American Honda Motor Co., Inc.

Getting Started: Basic Features and Functions

BLUETOOTH® HANDSFREELINK® AND VOICE COMMAND SYSTEM

Wirelessly connects your compatible cell phone to the vehicle's audio system, allowing for hands-free phone call operation. Turn on your phone's *Bluetooth* and make sure it's in discovery mode. The vehicle must be stopped during the entire pairing process.

Color Audio Pairing (LX, Sport)

– Press Phone Button

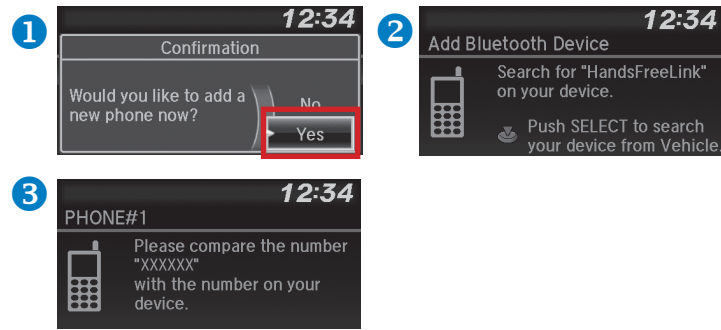

MEDIA DEVICE PORTS

Allows connection of your compatible mobile device to your vehicle. Functions range from playing media, charging devices and connecting to available Apple CarPlay™ or Android Auto™.

Front Console (All)

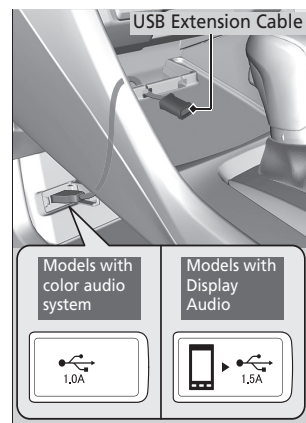

Center Console Compartment (EX, Sport Touring, Type R)

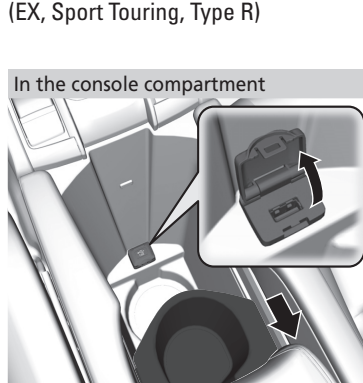

USB Ports	Front Console		Center Console
	1.5A	1.0A	1.0A
Color Audio (LX, Sport)		•	
Display Audio (EX, EX-L Navi, Sport Touring, Type R)	•		•
Functions	Quick Charging	Charging	Charging
	Play Media		
	Android Auto	Play Media	Play Media
	Apple CarPlay		

WALK AWAY AUTO LOCK®

(EX, EX-L Navi, Sport Touring, Type R)

Automatically locks vehicle when you walk away while carrying the remote transmitter. Especially useful when your hands are full or if you accidentally forget to lock your vehicle.

The fuel-fill door auto-locks as well, so ensure the vehicle is unlocked before you begin refueling.

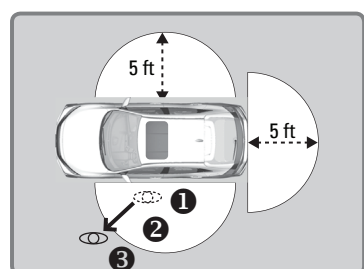

Follow the steps in the diagram:

- Exit vehicle, close all doors and hatch, then stay close and listen for a beep indicating the system is activated.
- Walk at least 5 feet away.
- Listen for a beep and look for the lights to flash, which confirm the doors are locked.

Note: You may experience interference due to proximity of mobile device

Display Audio Pairing (EX, EX-L Navi, Sport Touring, Type R)

– Press Settings, then Phone



AUDIO SYSTEM CONTROLS

Your vehicle comes with one of two great-sounding audio systems.

Color Audio / Display Audio (All models)



- i button:** Press to switch display.
- +/- bar:** Press the ends of the bar to adjust audio volume.
- ▲/▼ buttons:** Press to cycle through audio modes.

ELECTRIC PARKING BRAKE

Use the parking brake to keep the vehicle stationary when parked. When the parking brake is applied, you can manually or automatically release it.



To Apply:

Pull the electric parking brake switch up gently and securely.

- The indicator in the switch comes on.
- The parking brake and brake system indicator (red) comes on.



To Release:

- Depress the brake pedal
 - Press the electric parking brake switch.
- The indicator in the switch goes off.
 - The parking brake and brake system indicator (red) goes off.

TIRE PRESSURE MONITORING SYSTEM (TPMS) CALIBRATION

You must start TPMS calibration every time you adjust the pressure in one or more tires, rotate the tires, or replace one or more tires. Before calibrating the TPMS, set the cold tire pressure in all four tires.

- Make sure vehicle is at a complete stop.
- Make sure shift lever is in N for manual transmission models and P for continuously variable transmission models.
- Make sure ignition switch is ON. (Models with Smart Entry have an **ENGINE START/STOP** button instead of an ignition switch.)

Models with Color Audio: (Sport, LX)

- Press the **i** button, then **▲/▼** buttons to select **Vehicle Settings** and press the **ENTER** button. **TPMS Calibration** appears on the display.
- Press the **ENTER** button.
- Press the **▲/▼** buttons and select **Calibrate**, then press the **ENTER** button. **Calibration Started** screen appears, then returns to menu screen. The calibration process finishes automatically.

Models with Display Audio: (EX, EX-L Navi, Sport Touring, Type R)

- Press the **Home** button.
- Select **Settings**.
- Select **Vehicle**.
- Select **TPMS Calibration**.
- Select **Calibrate**. The calibration process finishes automatically.