

	Smart Entry	Walk Away Auto Lock®	Bluetooth® HandsFreeLink®	Media Device Ports	Audio Systems	SiriusXM® Radio	Adaptive Cruise Control	Lane Keep Assist System	Forward Collision Warning	Road Departure Mitigation	Power Tailgate
LX			•	•	Color Audio						
EX	•	•	•	•	Display Audio	•	•	•	•	•	
EX-L	•	•	•	•	Display Audio	•	•	•	•	•	•
Touring	•	•	•	•	Display Audio	•	•	•	•	•	Plus Hands-Free Access

## Let's personalize your vehicle.

Your vehicle has many customized settings. Refer to your Owner's Guide or Owner's Manual to see them in more detail.

### AUTO DOOR LOCK: When do the doors automatically lock? (All models)

- ☐ With Vehicle Speed Doors and tailgate lock when vehicle speed reaches approximately 10 mph.
- ☐ Shifting From Park (EX, EX-L, Touring) Doors and tailgate lock when shift lever is moved out of Park (P).
- ☐ OFF Auto door lock function deactivated.

### AUTO DOOR UNLOCK: When do the doors automatically unlock? (All models)

- ☐ All Doors When Driver's Door Opens Doors and tailgate unlock when driver's door is opened.
- ☐ All Doors When Shifted to Park Doors and tailgate unlock when shift lever is moved to Park (P) with brake pedal depressed.
- ☐ All Doors When Ignition Switched Off (EX, EX-L, Touring) Doors and tailgate unlock when power mode is set to VEHICLE OFF (LOCK).
- ☐ OFF Auto door-unlock function deactivated.

### KEY AND REMOTE UNLOCK MODE SETTINGS (EX, EX-L, Touring)

- ☐ Driver's Door Only ☐ All Doors

### REMOTE TRANSMITTER SETTINGS: Store a separate driver's seat setting into each of the two Remote Transmitters. The seat automatically adjusts when the vehicle is turned on. (EX-L, Touring)

- ☐ Program Transmitter 1 ☐ Program Transmitter 2

### DOOR UNLOCK MODE: Changes which doors unlock when you grab the driver's door handle. (EX, EX-L, Touring)

- ☐ Driver's Door Only ☐ All Doors

### RADIO PRESETS: Show the customer how to store a station.

1. Use the TUNE, SEEK or SCAN function to tune to a desired station or channel.
2. Pick a preset number button (1-6 or 7-12, as appropriate).
3. Press and hold the button until you hear a beep.

AM

### WALK AWAY AUTO LOCK®: Select whether the vehicle automatically locks when you walk away with the keyless access remote. (EX, EX-L, Touring)

- ☐ ON ☐ OFF

### ADAPTIVE CRUISE CONTROL (ACC) FORWARD VEHICLE DETECT BEEP: Select whether the ACC system beeps when it detects a vehicle or when a detected vehicle goes out of ACC range. (EX, EX-L, Touring) Video available at [hondatechtutor.com](http://hondatechtutor.com)

- ☐ ON ☐ OFF

### LANE KEEPING ASSIST SYSTEM (LKAS) SUSPEND BEEP: Select whether the system beeps when the LKAS is suspended. (EX, EX-L, Touring) Video available at [hondatechtutor.com](http://hondatechtutor.com)

- ☐ ON A beep confirms each time the system suspends (does not detect lane markings). ☐ OFF The system remains silent when it no longer detects lane markings.

### FORWARD COLLISION WARNING DISTANCE: Change the distance at which Collision Mitigation Braking System™ alerts. (EX, EX-L, Touring) Video available at [hondatechtutor.com](http://hondatechtutor.com)

- ☐ LONG ☐ NORMAL ☐ SHORT

### ROAD DEPARTURE MITIGATION (RDM) SETTING: Change the setting for the RDM system. (EX, EX-L, Touring) Video available at [hondatechtutor.com](http://hondatechtutor.com)

- ☐ NORMAL ☐ WIDE ☐ WARNING ONLY

### AUDIO CONTROLS: Show customer how to use the steering wheel and in-dash audio controls

### APPLE CARPLAY™ / ANDROID AUTO™ (EX, EX-L, Touring): Offer to plug customer's USB cable into the port and show how to activate.

### COMPATIBLE PHONE PAIRED: Show customer how to pair compatible phone

### REMOTE TRANSMITTER: Explain to customer they may experience interference due to proximity of mobile device to remote transmitter

Note: SiriusXM® Radio will not function in Alaska, Puerto Rico or Hawaii.

FM

FM

SXM

SXM

### FOR MORE INFORMATION

Visit [owners.honda.com](http://owners.honda.com) and

[hondatechtutor.com](http://hondatechtutor.com)

Honda Customer Service: 1-800-999-1009

Monday through Friday: 6:00 AM to 5:00 PM - PT

[Twitter.com/HondaCustSvc](https://twitter.com/HondaCustSvc)

Technology Support: 1-888-528-7876

Monday through Friday: 6:00 AM to 5:00 PM - PT

Saturdays: 7:30 AM to 4:00 PM - PT

Owner's Guide located in glove box

Owner's Manual + Navigation Manual on website: [owners.honda.com](http://owners.honda.com)

For frequently asked questions, try our Virtual Chat: <https://hondaweb.com/a2q/chat/?psw>

For more information on Android Auto™: [android.com/auto/](http://android.com/auto/)

For more information on Apple CarPlay™: [apple.com/ios/carplay/](http://apple.com/ios/carplay/)



Honda How to Playlist  
[hondahowtovideos.com](http://hondahowtovideos.com)

Videos on how to use various Honda technologies.



HondaLink® (EX, EX-L, Touring)

Downloadable Honda app which provides access to your vehicle's information through your smartphone. For more information, visit [hondalink.com](http://hondalink.com)

Customer's Name: \_\_\_\_\_ Initials: \_\_\_\_\_ VIN#: \_\_\_\_\_

Sales Consultant/Delivery Specialist \_\_\_\_\_ Initials: \_\_\_\_\_ Date: \_\_\_\_\_

The information herein is believed to be accurate at time of printing. It is offered without warranty or assumption of responsibility by American Honda Motor Co., Inc.

## Getting Started: Basic Features and Functions

### BLUETOOTH® HANDSFREELINK® AND VOICE COMMAND SYSTEM

Wirelessly connects your compatible cell phone to the vehicle's audio system, allowing for hands-free phone call operation. Turn on your phone's *Bluetooth* and make sure it's in discovery mode. The vehicle must be stopped during the entire pairing process.

#### Color Audio Pairing (LX) – Press Phone Button

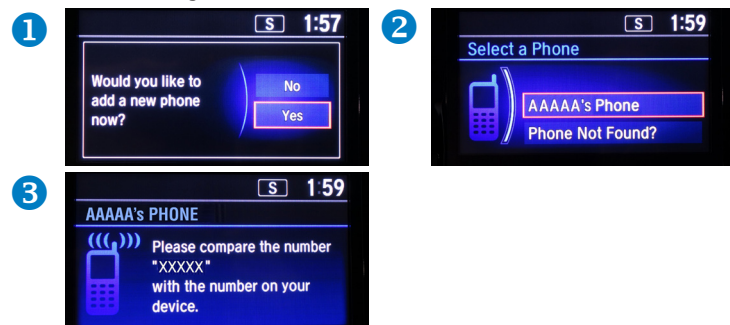

#### Display Audio Pairing (EX, EX-L, Touring) – Press Settings, then Phone



### MEDIA DEVICE PORTS

Allows connection of your compatible mobile device to your vehicle. Functions range from playing media, charging devices and connecting to available Apple CarPlay™ or Android Auto™.

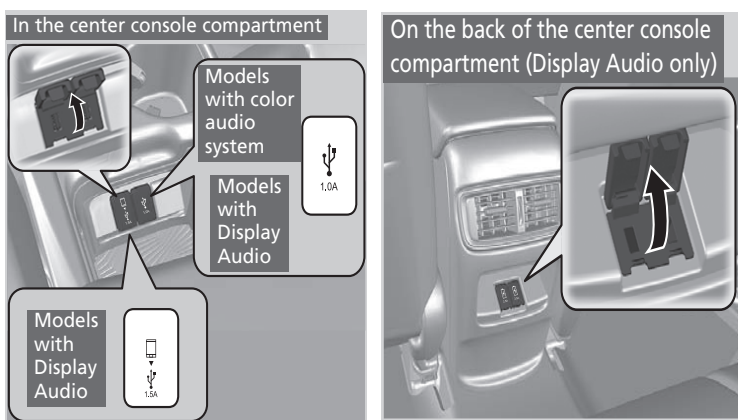

Center Console USB Ports	Inside Center Console		Rear Passenger Area
	1.5A	1.0A	2.5A
Color Audio (LX)		•	
Display Audio (EX, EX-L, Touring)	•	•	•
Functionality	Quick Charging	Charging	High-speed Charging Only
	Play Audio		
	Android Auto™ Apple CarPlay™	Play Audio	

### WALK AWAY AUTO LOCK® (EX, EX-L, Touring)

Automatically locks vehicle when you walk away while carrying the remote transmitter. Especially useful when your hands are full or if you accidentally forget to lock your vehicle.

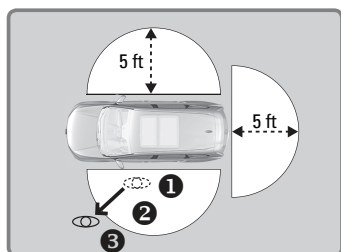

#### Follow the steps in the diagram:

- Exit vehicle, close all doors and trunk, then stay close and listen for a beep indicating the system is activated.
- Walk at least 5 feet away.
- Listen for a beep and look for the lights to flash which confirms the doors are locked.

**Note:** You may experience interference due to proximity of mobile device

### AUDIO SYSTEM CONTROLS

Your vehicle comes with one of two great-sounding audio systems.

#### Color Audio (LX)



- SOURCE button:** Cycle through available audio modes.
- + / - buttons:** Adjust audio volume.
- ◀ / ▶ buttons:** Change radio station presets, tracks, albums, or folders.

#### Display Audio (EX, EX-L, Touring)



- ENTER button:** Press until the audio screen is displayed in the Driver Information Interface.
- + / - bar:** Press the ends of the bar to adjust audio volume.
- ◀ / ▶ buttons:** Change radio station presets, tracks, albums, or folders.



- POWER button/Volume**
- SEEK/SKIP**
- BRIGHTNESS**



- POWER button/Volume**
- DAY/NIGHT button**

### POWER TAILGATE (EX-L, Touring): While carrying remote transmitter Stop and Hold (to prevent from opening all the way):

After starting opening sequence, simply stop the tailgate in the desired position by pressing the Remote Transmitter tailgate button. It will hold until closing sequence is started.

#### Opening Height Setting (to set a desired opening height):

As tailgate is opening, stop it near the desired height by pressing the Remote Transmitter or INNER BUTTON on the tailgate once. Then manually adjust the tailgate to the desired height. Press and hold the INNER BUTTON until you hear a double-beep to confirm the new height is set.



### HANDS-FREE ACCESS POWER TAILGATE (Touring)

Use a forward and back kicking motion under the center of the rear bumper to open or close the power tailgate while carrying the smart entry remote. *If you hold your foot under the bumper for too long, the power tailgate will not open or close.*

